

T-12-N R-12-E
SHEET-15

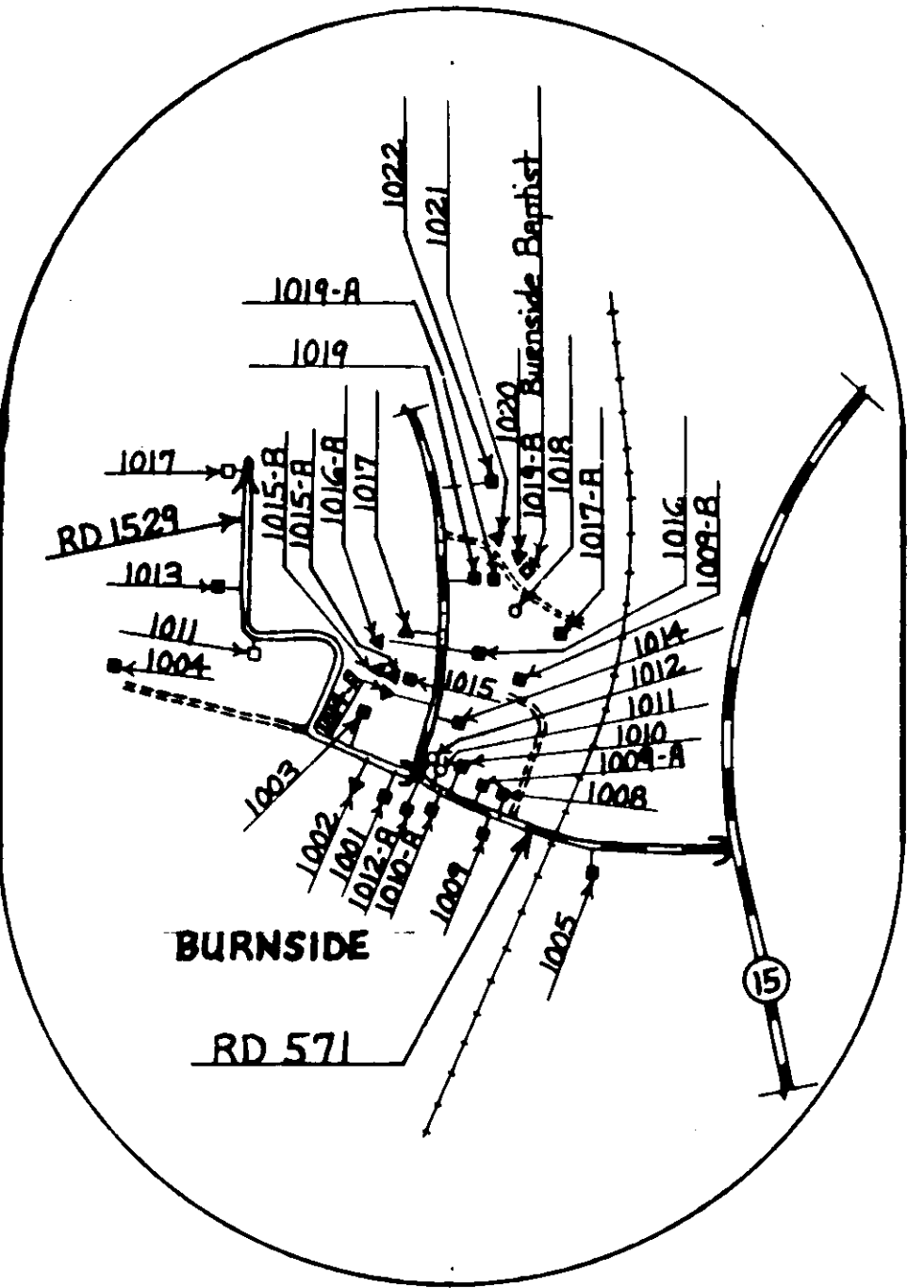
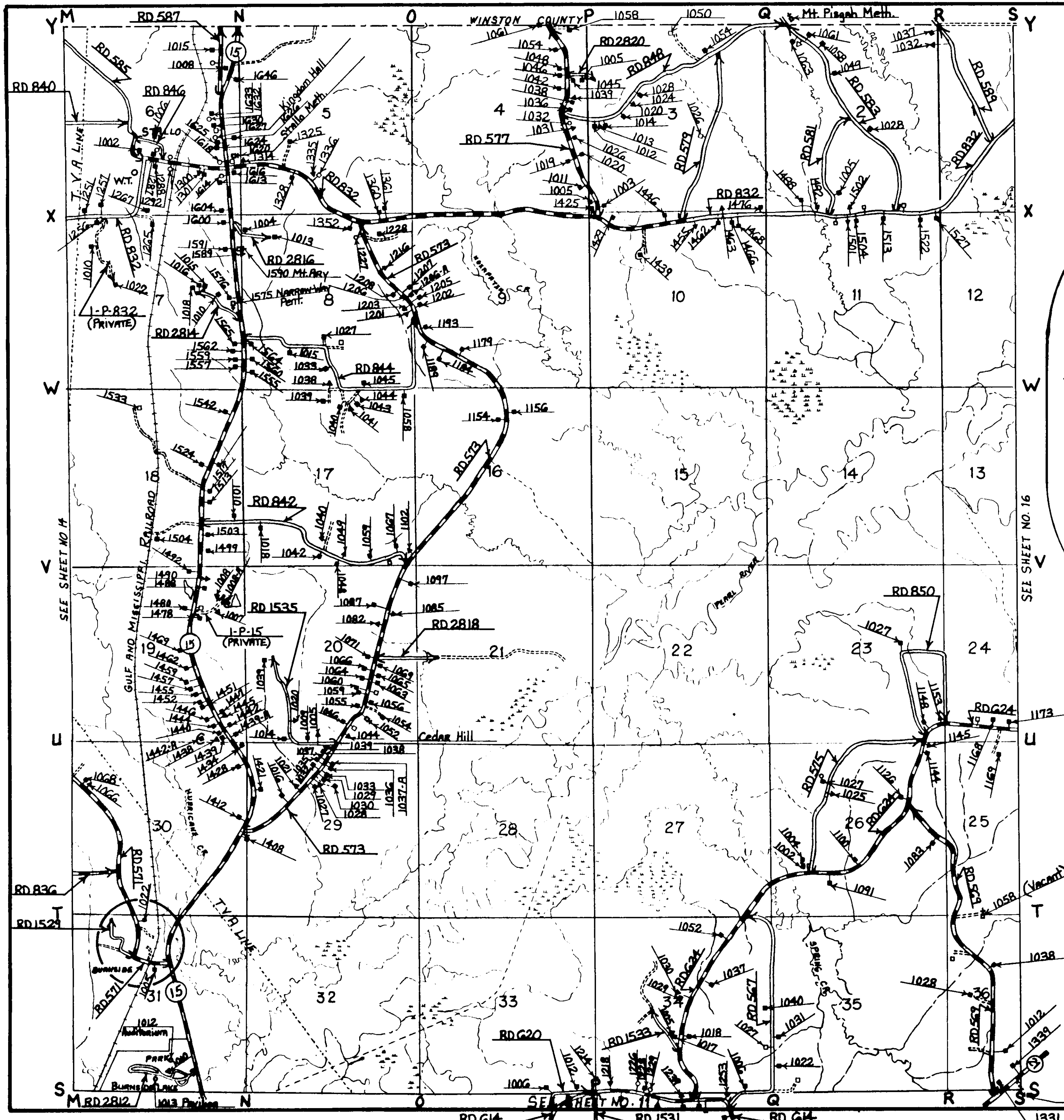

NESHOBA COUNTY
ROAD AND HOUSE NUMBERING SYSTEM
FOR THE
NESHOBA COUNTY BOARD OF SUPERVISORS

COX ENGINEERING Tom W. Cox P.O. Box 683 PHILADELPHIA, MS. 39350	TELEPHONE:	SHEET NO. 15 OF 16
	—OFFICE— G01-656-3711 —HOME— G01-656-1204	

COPYRIGHT © 1964 BY TOM W. COX, ENGINEER